

Straight Run Steel track systems

200

300

450

700

2000



STEEL TRACK

Maximum door weight	200kg	300kg	450kg	700kg	2000kg
Maximum door height	3000mm	3000mm	4200mm	4800mm	6000mm
Door thickness	35-48mm	35-48mm	43-57mm	43-57mm	60-70mm



TYPE 1 BRACKET

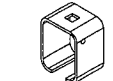

TYPE 2 BRACKET

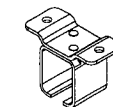

TYPE 3 BRACKET

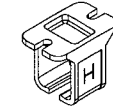

TYPE 4 BRACKET

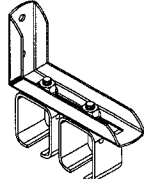

TYPE 5 BRACKET

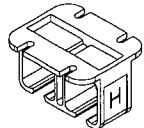

TYPE 6 BRACKET

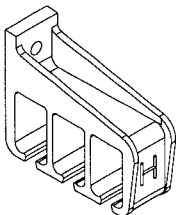

TYPE 7 BRACKET

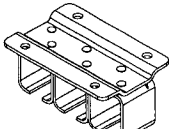

TYPE 8 BRACKET

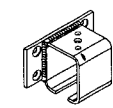

TYPE 9 BRACKET



TYPE A END CLIP

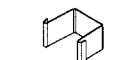

TYPE S END CLIP

TRACKS – Steel

	Ref. No.	Price \$	Ref. No.	Price \$	Ref. No.	Price \$	Ref. No.	Price \$	Ref. No.	Price \$
2000mm	290-20	41.10	301-20	65.60	301H-20	99.50	305-20	147.00	307-20	305.70
3000mm	290-30	61.60	301-30	98.40	301H-30	149.50	305-30	220.60	307-30	458.70
4000mm	290-40	81.90	301-40	131.00	301H-40	199.40	305-40	294.00		
6000mm	290-60	123.10	301-60	196.50	301H-60	298.90				

BRACKETS – For steel tracks

Type 1 Face Fit – open	1A/290	9.40	IS/301	11.70	IS/301	11.70	I/305O	39.70	IS/307O	44.20
			I/301O	20.70	I/301O	20.70				
– left closed			I/301L	20.70	I/301L	20.70	I/305L	39.70	IS/307L	44.20
– right closed			I/301R	20.70	I/301R	20.70	I/305R	39.70	IS/307R	44.20
– jointing	1AX/290	11.80	ISX/301	13.80	IX/301	22.80	IX/305	36.30	ISX/307	52.50
Type 2 Soffit Fit – open	2S/290	8.00	2S/301	11.10	2S/301	11.10	2S/305	24.20	2S/307	25.90
Type 3 Soffit Fit – open	3A/290	14.60	3S/301	17.00	3S/301	17.00	3/305O	67.30	3S/307O	74.90
– closed						3/305C	67.30	3S/307C	96.00	
– jointing	3AX/290	16.60	3SX/301	19.20	3SX/301	19.20	3X/305	69.70	3SX/307	139.90
Type 4 Soffit Fit – open	4A/290	20.20	4A/301	39.00	4A/301	39.00	4/305O	79.00	4S/307O	72.00
			4S/301	28.80	4S/301	28.80				
– closed						4/305C	79.00	4S/307C	91.10	
– jointing	4AX/290	21.10	4AX/301	56.60	4AX/301	56.60	4X/305	75.30	4SX/307	75.20
			4SX/301	34.30	4SX/301	34.30				
Type 5 Face Fit – open	5A/290	31.60	5S/301	41.20	5S/301	41.20	5/305O	105.70	5S/307O	150.90
– left closed						5/305L	105.70	5S/307L	150.90	
– right closed						5/305R	105.70	5S/307R	150.90	
Type 6 Soffit Fit – open			6A/301	63.90	6A/301	63.90	6/305O	154.70		
– closed						6/305C	154.70			
Type 7 Face Fit – open			7/301O	176.60	7/301O	176.60	7/305O	P.O.A.		
– left closed			7/301L	176.60	7/301L	176.60	7/305L	P.O.A.		
– right closed			7/301R	176.60	7/301R	176.60	7/305R	P.O.A.		
Type 8 Soffit Fit – open			8S/301O	58.30	8S/301O	58.30	8/305O	145.50		
– closed						8/305C	145.50			
Type 9 Face Fit – open						9A/305O	60.30			
–	9A/290	16.60	9S/301	30.00	9S/301	30.00	9/305O	79.20	9S/307O	73.00
– left closed						9/305L	79.20	9S/307L	73.00	
– right closed						9/305R	79.20	9S/307R	73.00	

BRACKET END CLIPS – For steel track brackets

For aluminium brackets	A/290EC	3.80	A/301EC	3.80	A/301EC	3.80
For pressed steel brackets			S/301EC	3.80	S/301EC	3.80

Bracket End Clips. If no closed brackets are available for a certain type of bracket, the end clips convert an open bracket into a closed bracket. Closed brackets are essential to stop the track moving and are not to be used as door stops.

Straight Run Steel track systems

200 300 450 700 2000

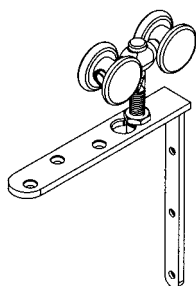

52 HANGER

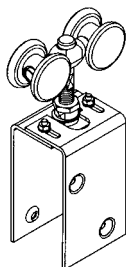

53 HANGER

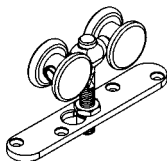

57 HANGER



56 HANGER

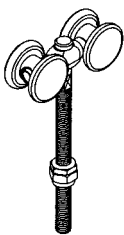

56L HANGER

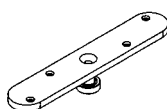

106RB/94 GUIDE

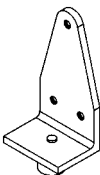

105R/97 GUIDE



104P/97 GUIDE

Maximum door weight	200kg	300kg	450kg	700kg	2000kg
Maximum door height	3000mm	4200mm	4200mm	4800mm	6000mm
Door Thickness	35-48mm	43-57mm	43-57mm	43-57mm	60-70mm

HANGERS – For timber doors

	Ref. No.	Price \$	Ref. No.	Price \$	Ref. No.	Price \$	Ref. No.	Price \$	Ref. No.	Price \$
Type 52, nylon wheels & carbon steel bearings	52KN	48.10	52AN	94.30	52AN	94.30				
Type 52, nylon wheels & stainless steel bearings	52SSKN	118.60								
Type 52, steel wheels & carbon steel bearings	52KS	43.10	52AS	88.10	52AS	88.10	52CS	101.40		
Type 53, nylon wheels & carbon steel bearings	53KN	52.30	53AN	102.80	53AN	102.80				
Type 53, steel wheels & carbon steel bearings	53KS	47.10	53AS	101.40	53AS	101.40	53CS	109.00	53FJS	P.O.A.
Type 57, nylon wheels & carbon steel bearings	57KN	42.10	57AN	87.00	57AN	87.00				
Type 57, nylon wheels & stainless steel bearings	57SS/KN	108.90								
Type 57, steel wheels & carbon steel bearings	57KS	40.20	57AS	87.00	57AS	87.00	57CS	94.30		

HANGERS – For metal doors

Type 56, nylon wheels & carbon steel bearings	56KN	36.30	56AN	74.10	56AN	74.10				
Type 56, nylon wheels & stainless steel bearings	56SS/KN	93.20								
Type 56, steel wheels & carbon steel bearings	56KS	32.50	56AS	74.10	56AS	74.10	56CS	81.20	56FJS	277.40
Type 56L, nylon wheels & carbon steel bearings	56KLN	37.90	56ALN	82.60	56ALN	82.60				
Type 56L, nylon wheels & stainless steel bearings	56SS/KLN	97.60								
Type 56L, steel wheels & carbon steel bearings	56KLS	34.20	56ALS	82.60	56ALS	82.60	56CLS	90.10	56FJLS	325.70

GUIDES requiring channel

Use with types 52 and 57 hangers	106RB/94	17.70	106R/97	11.80	106R/97	11.80	106R/97	11.80		
Use with type 53 hanger	105R/97	24.60	102/97	27.70	102/97	27.70	102/97	27.70	102/97	27.70
Use with type 56 hanger	104P/97	21.80	104P/97	21.80	104P/97	21.80	104P/97	21.80	104P/97	21.80
Use with type 56L hanger	104PL/97	24.60	104PL/97	24.60	104PL/97	24.60	104PL/97	24.60	104PL/97	24.60
Use with multiple doors	102VV/94	25.50								

GUIDES – No channel required

Wall mounted – single run	31S	22.90	31S	22.90	31S	22.90	31S	22.90		
Wall mounted – double run	31D	27.70	31D	27.70	31D	27.70	31D	27.70		
Mount on timber floor	112	31.90	112	31.90	112	31.90	112	31.90		
Mount on concrete floor	126HDA	81.90	126HDA	81.90	126HDA	81.90	126HDA	81.90	126HDA	81.90
Mount on floor	128	64.40	128	64.40	128	64.40	128	64.40	128	64.40
Set in concrete floor	126	17.90	126H	57.00	126H	57.00	126H	57.00	126H	57.00
Use with sawcut in timber door	124	7.20								

Straight Run

200

300

450

700

2000

Maximum door weight	200kg	300kg	450kg	700kg	2000kg
Maximum door height	3000mm	4200mm	4200mm	4800mm	6000mm
Door Thickness	35-48mm	43-57mm	43-57mm	43-57mm	60-70mm

CHANNEL

	Ref. No.	Price \$	Ref. No.	Price \$	Ref. No.	Price \$	Ref. No.	Price \$	Ref. No.	Price \$
Aluminium mill 2000mm	94A-20	23.30								
Aluminium mill 3000mm	94A-30	34.60								
Aluminium mill 4000mm	94A-40	46.30								
Aluminium mill 6000mm	94A-60	69.50								
Aluminium anod 2000mm	94A-A20	29.80								
Aluminium anod 3000mm	94A-A30	44.70								
Aluminium anod 4000mm	94A-A40	59.50								
Aluminium anod 6000mm	94A-A60	89.20								
Polypropylene Blk 2000mm	94P-20	15.50								
Polypropylene Blk 3000mm	94P-30	23.10								
Polypropylene Blk 4000mm	94P-40	30.80								
Polypropylene Blk 6000mm	94P-60	46.30								
Poly. + Alu. Mill 2000mm	94PPA-20	38.70								
Poly. + Alu. Mill 3000mm	94PPA-30	57.50								
Poly. + Alu. Mill 4000mm	94PPA-40	76.90								
Poly. + Alu. Mill 6000mm	94PPA-60	115.50								
Poly. + Alu. Anod. 2000mm	94PPA-A20	45.00								
Poly. + Alu. Anod. 3000mm	94PPA-A30	67.50								
Poly. + Alu. Anod. 4000mm	94PPA-A40	89.90								
Poly. + Alu. Anod. 6000mm	94PPA-A60	134.90								
Brass 2000mm	94B-20	66.20								
Brass 3000mm	94B-30	99.50								
Brass 4000mm	94B-40	132.60								
Brass 6000mm	94B-60	198.80								
Galvanised steel 2000mm	100-20	47.20	100-20	47.20	100-20	47.20	100-20	47.20	100-20	47.20
Galvanised steel 3000mm	100-30	70.70	100-30	70.70	100-30	70.70	100-30	70.70	100-30	70.70
Galvanised steel 4000mm	100-40	94.40	100-40	94.40	100-40	94.40	100-40	94.40	100-40	94.40
Galvanised steel 2000mm	97-20	63.70	97-20	63.70	97-20	63.70	97-20	63.70	97-20	63.70
Galvanised steel 3000mm	97-30	95.40	97-30	95.40	97-30	95.40	97-30	95.40	97-30	95.40
Galvanised steel 4000mm	97-40	127.30	97-40	127.30	97-40	127.30	97-40	127.30	97-40	127.30

RAIL

Galvanised steel 2000mm	299-20	69.10	299-20	69.10	299-20	69.10	299-20	69.10	299-20	69.10
Galvanised steel 3000mm	299-30	103.90	299-30	103.90	299-30	103.90	299-30	103.90	299-30	103.90

ACCESSORIES

Interlocker Bz. Anod. 4800mm	924-BZ48	69.30	924-BZ48	69.30						
Door stop – Polished Brass	110PB	18.30	110PB	18.30	110PB	18.30	110PB	18.30	110PB	18.30
Door stop – Satin Chrome	110SC	18.30	110SC	18.30	110SC	18.30	110SC	18.30	110SC	18.30
Flush Pull – Titanium Gold	401B	17.70	401B	17.70						
Flush Pull – Pol. Nickel	401C	17.70	401C	17.70						
Flush Pull – Satin Nickel	401S	17.70	401S	17.70						
Flush pull – iron – zinc plate	413	54.20	413	54.20	414	12.00	414	12.00		
Door stop – wall or floor mounted	109	19.40	109	19.40	109	19.40	109	19.40		
Door stop – steel track	200DS	8.20	301DS	8.90	301DS	8.90				

