

Pivotfold, Centrefold, Endfold

20

45

75



250 TRACK



180 TRACK



120 TRACK



SS/250 BRACKET

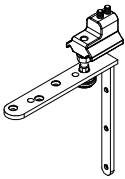

21HP PIVOT SET

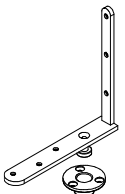

21GN HANGER

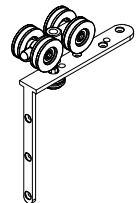

21/4 HANGER



61/4 HANGER

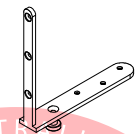

21RB/94 GUIDE



06RB/94 GUIDE

Maximum leaf weight	20kg	45kg	75kg
Maximum leaf height	3000mm	3000mm	3300mm
Maximum leaf width	900mm	900mm	900mm
Maximum leaf width (Centrefold)	920mm	920mm	1000mm
Maximum leaf thickness	19-40mm	35-50mm	35-50mm

STANDARD PACK – Fittings Only (All packs include 57ENP Hanger, 20DS Stop and 282SS Hinges)

ENDFOLD/CENTREFOLD

	Ref. No.	Price \$	Ref. No.	Price \$	Ref. No.	Price \$
2 Door Pack	EF2	58.80				
4 Door Pack – with 106E/94 Guide	EF4	141.80				
6 Door Pack – with 106E/94 Guide	EF6	210.10				

PIVOTFOLD (All packs include Pivot Set and 106E/94 Guide except PF2-NC and PF2-A)

2 Door Pack	PF2	124.40				
2 Door Add-on Pack – No Pivot Set	PF2-A	63.50				
No Channel 2 Door Pk – No Guide	PF2-NC	98.40				
4 Door Pack	PF4	192.90				
6 Door Pack	PF6	261.40				

TRACK – Aluminium mill finish

	Ref. No.	Price \$	Ref. No.	Price \$	Ref. No.	Price \$
2000mm	120-20	37.70	180-20	53.80	250-20	75.60
3000mm	120-30	56.40	180-30	80.60	250-30	113.30
4000mm	120-40	75.20	180-40	107.50	250-40	151.10
6000mm	120-60	112.90	180-60	161.20	250-60	226.80

TRACK – Aluminium anodised

2000mm	120-A20	53.00	180-A20	70.00	250-A20	97.10
3000mm	120-A30	79.40	180-A30	104.80	250-A30	145.90
4000mm	120-A40	105.90	180-A40	139.70	250-A40	194.30
6000mm	120-A60	158.90	180-A60	209.70	250-A60	291.40

BRACKETS – For aluminium tracks

Type 1 face fitted	ISS/250	13.90	ISS/250	13.90	ISS/250	13.90
--------------------	---------	-------	---------	-------	---------	-------

PIVOT SETS – Pivotfold only

Top and Bottom Pivots	21EP	66.10	21HP	107.90	21HP	107.90
No Channel	21EPNC	54.60				

HANGERS – Pivotfold & Endfold

2 wheel			21GN	56.30	21HN	61.20
4 wheel	57EN	36.00	21/4GN	65.00	21/4HN	69.70
4 wheel plastic body	57ENP	24.00				

HANGERS – Centrefold

4 wheel	57EN	36.00	61/4GN	64.30	61/4HN	69.00
4 wheel plastic body	57ENP	24.00				

GUIDES – Pivotfold & Endfold

Stainless steel with precision bearing	106E/94	14.50	21RB/94	28.00	21RB/94	28.00
--	---------	-------	---------	-------	---------	-------

GUIDES – Centrefold

Stainless steel with precision bearing	106E/94	14.50	106RB/94	17.70	106RB/94	17.70
--	---------	-------	----------	-------	----------	-------

DOOR STOPS

20DS	9.80
------	------



21EPNC PIVOT SET



21EP PIVOT SET



57EN HANGER



20DS DOOR STOP



106E/94 GUIDE



Pivotfold, Centrefold, Endfold

20

45

75

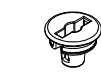
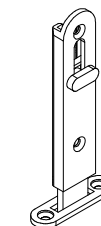
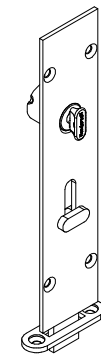
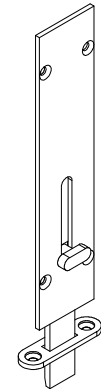
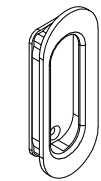

	Ref. No	Price \$	Ref. No.	Price \$	Ref. No.	Price \$
CHANNEL						
Aluminium mill 2000mm	94A-20	23.30	94A-20	23.30	94A-20	23.30
Aluminium mill 3000mm	94A-30	34.60	94A-30	34.60	94A-30	34.60
Aluminium mill 4000mm	94A-40	46.30	94A-40	46.30	94A-40	46.30
Aluminium mill 6000mm	94A-60	69.50	94A-60	69.50	94A-60	69.50
Aluminium anod 2000mm	94A-A20	29.80	94A-A20	29.80	94A-A20	29.80
Aluminium anod 3000mm	94A-A30	44.70	94A-A30	44.70	94A-A30	44.70
Aluminium anod 4000mm	94A-A40	59.50	94A-A40	59.50	94A-A40	59.50
Aluminium anod 6000mm	94A-A60	89.20	94A-A60	89.20	94A-A60	89.20
Polypropylene Blk 2000mm	94P-20	15.50	94P-20	15.50	94P-20	15.50
Polypropylene Blk 3000mm	94P-30	23.10	94P-30	23.10	94P-30	23.10
Polypropylene Blk 4000mm	94P-40	30.80	94P-40	30.80	94P-40	30.80
Polypropylene Blk 6000mm	94P-60	46.30	94P-60	46.30	94P-60	46.30
Poly. + Alu. Mill 2000mm	94PPA-20	38.70	94PPA-20	38.70	94PPA-20	38.70
Poly. + Alu. Mill 3000mm	94PPA-30	57.50	94PPA-30	57.50	94PPA-30	57.50
Poly. + Alu. Mill 4000mm	94PPA-40	76.90	94PPA-40	76.90	94PPA-40	76.90
Poly. + Alu. Mill 6000mm	94PPA-60	115.50	94PPA-60	115.50	94PPA-60	115.50
Poly. + Alu. Anod. 2000mm	94PPA-A20	45.00	94PPA-A20	45.00	94PPA-A20	45.00
Poly. + Alu. Anod. 3000mm	94PPA-A30	67.50	94PPA-A30	67.50	94PPA-A30	67.50
Poly. + Alu. Anod. 4000mm	94PPA-A40	89.90	94PPA-A40	89.90	94PPA-A40	89.90
Poly. + Alu. Anod. 6000mm	94PPA-A60	134.90	94PPA-A60	134.90	94PPA-A60	134.90
Brass 2000mm	94B-20	66.20	94B-20	66.20	94B-20	66.20
Brass 3000mm	94B-30	99.50	94B-30	99.50	94B-30	99.50
Brass 4000mm	94B-40	132.60	94B-40	132.60	94B-40	132.60
Brass 6000mm	94B-60	198.80	94B-60	198.80	94B-60	198.80
HINGES						
Hinge 65mm – S/S with Screws	282SS	5.00				
Butt 85x60 Stainless Satin	404/2S	14.50	404/2S	14.50	404/2S	14.50
Butt 100x75 Stainless Satin	404/3S	16.10	404/3S	16.10	404/3S	16.10
Butt 100x75 polished Stainless	404/3C	16.40	404/3C	16.40	404/3C	16.40
Butt 100x735 Brass	403/3B	11.10	403/3B	11.10	403/3B	11.10
ACCESSORIES						
Masonry Keeper Satin Stainless	360RKSS	13.30	360RKSS	13.30	360RKSS	13.30
Masonry Keeper Titanium Gold	360RKTG	13.30	360RKTG	13.30	360RKTG	13.30
Flush Bolt – Window Standard Polished Nickel	360PN	39.50	360PN	39.50	360PN	39.50
Flush Bolt – Window Standard Satin Nickel	360SN	39.50	360SN	39.50	360SN	39.50
Flush Bolt – Window Standard Titanium Gold	360TG	39.50	360TG	39.50	360TG	39.50
Flush Bolt – Window Lockable Polished Nickel	360EPN	52.90	360EPN	52.90	360EPN	52.90
Flush Bolt – Window Lockable Satin Nickel	360ESN	52.90	360ESN	52.90	360ESN	52.90
Flush Bolt – Window Lockable Titanium Gold	360ETG	52.90	360ETG	52.90	360ETG	52.90
Flush Pull – Titanium Gold	401B	17.70	401B	17.70	401B	17.70
Flush Pull – Polished Nickel	401C	17.70	401C	17.70	401C	17.70
Flush Pull – Satin Nickel	401S	17.70	401S	17.70	401S	17.70
Flush Bolt – Door Standard – Polished Nickel	456PN	59.50	456PN	59.50	456PN	59.50
Flush Bolt – Door Standard – Satin Nickel	456SN	59.50	456SN	59.50	456SN	59.50
Flush Bolt – Door Standard – Titanium Gold	456TG	59.50	456TG	59.50	456TG	59.50
Flush Bolt – Door Lockable – Polished Nickel	456EPN	74.60	456EPN	74.60	456EPN	74.60
Flush Bolt – Door Lockable – Satin Nickel	456ESN	74.60	456ESN	74.60	456ESN	74.60
Flush Bolt – Door Lockable – Titanium Gold	456ETG	74.60	456ETG	74.60	456ETG	74.60

