

Single Top 27 & Double Top 27

DOOR SPECIFICATION

- Maximum door weight 27kg
- Door thickness – single top 27 16mm min.
- double top 27 16-35mm

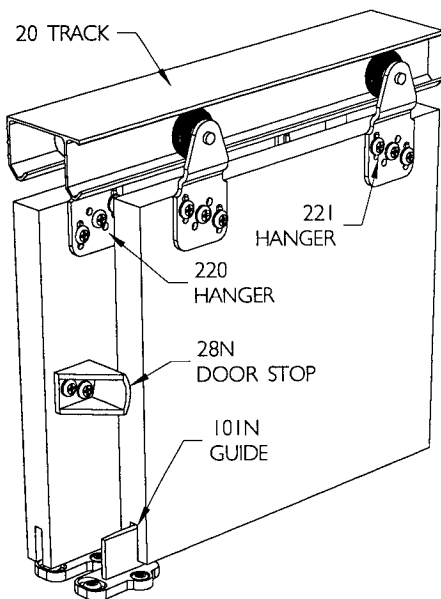

STANDARD SETS AND PACKS

Sets comprise top track, hangers, door stop(s), sawcut guide(s), all screws and installation instructions.

Opening width	Track length	Hardware for	Ref. No.	Price \$
Single Top 27				
600mm	1200mm	one door	ST4	35.30
750mm	1500mm	one door	ST5	38.20
900mm	1800mm	one door	ST6	41.10
Double Top 27				
1200mm	1200mm	two doors	4W	65.80
1500mm	1500mm	two doors	5W	71.80
1800mm	1800mm	two doors	6W	78.00
2400mm	2400mm	three doors	8W	112.80

Additional one door pack for adding one more door on above

Double Top 27 Sets			1W	27.70
--------------------	--	--	----	-------

If above Double Top 27 sets are not suitable, consider following fitting packs for use with bulk length of No. 20 track.

Two door pack of fittings for use with 20 track			2W	39.80
Three door pack of fittings for use with 20 track			3W	62.40

COMPONENTS

1200mm Single Top 27 track, aluminium, drilled	21-12	11.10
1500mm Single Top 27 track, aluminium, drilled	21-15	14.00
1800mm Single Top 27 track, aluminium, drilled	21-18	16.50
2400mm Single Top 27 track, aluminium, drilled	21-24	22.10
3000mm Single Top 27 track, aluminium, drilled	21-30	27.60
3600mm Single Top 27 track, aluminium, drilled	21-36	33.30
4800mm Single Top 27 track, aluminium, undrilled	21-48	43.70
1200mm Double Top 27 track, aluminium, drilled	20-12	25.40
1500mm Double Top 27 track, aluminium, drilled	20-15	31.90
1800mm Double Top 27 track, aluminium, drilled	20-18	38.20
2400mm Double Top 27 track, aluminium, drilled	20-24	51.00
3000mm Double Top 27 track, aluminium, drilled	20-30	63.80
3600mm Double Top 27 track, aluminium, drilled	20-36	76.50
4800mm Double Top 27 track, aluminium, undrilled	20-48	102.20
Hanger Single or Double Top 27 – white ballrace wheel	220	7.40
Hanger Double Top 27 – coloured ballrace wheel	221	7.40
Hanger Double Top 27 – reversible ballrace wheel	222	8.70
Door stop, nylon, including screws	28N	1.80
Sawcut guide, nylon, including screws	101N	2.10
Surface guide for single top	24/24N	2.40
Surface guide – suitable for any door thickness	24/25N	5.90
1200mm channel, aluminium, drilled and countersunk	81-12	11.10
1500mm channel, aluminium, drilled and countersunk	81-15	14.00
1800mm channel, aluminium, drilled and countersunk	81-18	16.50
2400mm channel, aluminium, drilled and countersunk	81-24	22.10
3600mm channel, aluminium, drilled and countersunk	81-36	33.30
Guide, nylon – for use with 81 channel (pair)	113N/81	2.40

ALTERNATIVE GUIDE SYSTEMS



113N/81 GUIDE
and 81 CHANNEL

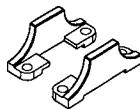

24/24N GUIDE
FOR SINGLE TOP 27

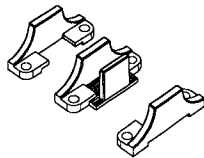

24/25 GUIDE
FOR DOUBLE TOP 27