

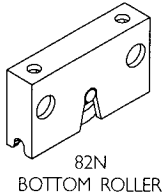

Timberoll 25

DOOR SPECIFICATION

- Maximum door weight 25kg
- Maximum door width 900mm
- Minimum door thickness 16mm

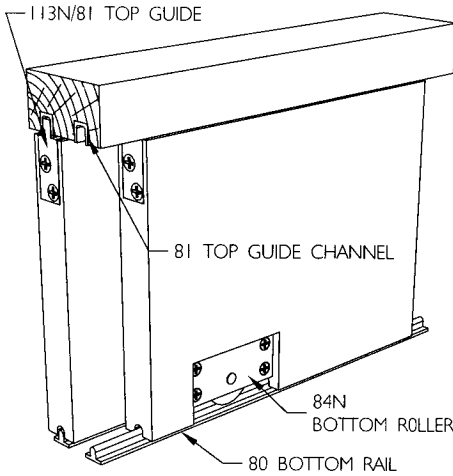

STANDARD SETS

Standard sets are available for bi-passing or bi-parting doors. Sets comprise two top guide channels, two bottom rails, four top guides, four No. 84N bottom rollers, all screws and installation instructions.

Opening width	Ref. No.	Price \$
1200mm for 2 doors	TR4	79.10
1500mm for 2 doors	TR5	89.80
1800mm for 2 doors	TR6	98.90

COMPONENTS

1200mm bottom rail – aluminium – drilled & countersunk	80-12	11.30
1500mm bottom rail – aluminium – drilled & countersunk	80-15	14.00
1800mm bottom rail – aluminium – drilled & countersunk	80-18	16.90
2400mm bottom rail – aluminium – drilled & countersunk	80-24	22.40
3600mm bottom rail – aluminium – drilled & countersunk	80-36	33.60
1200mm top guide channel – aluminium – drilled & countersunk	81-12	11.10
1500mm top guide channel – aluminium – drilled & countersunk	81-15	14.00
1800mm top guide channel – aluminium – drilled & countersunk	81-18	16.50
2400mm top guide channel – aluminium – drilled & countersunk	81-24	22.10
3600mm top guide channel – aluminium – drilled & countersunk	81-36	33.30
Bottom roller – mortice or face fitted – Pair	82N	12.60
Bottom roller – face fitted-as supplied in sets – Pair	84N	15.40
Top guide – nylon – as supplied in sets – Pair	113N/81	2.40
Door stop – nylon	28N	1.80

Timberoll

55 170 270

Maximum door weight	55kg	170kg	270kg
Maximum door height	2600mm	2600mm	3300mm
Minimum door thickness	25mm	35mm	44mm

TOP GUIDE TEE – 25x25x3

	Ref. No.	Price \$	Ref. No.	Price \$	Ref. No.	Price \$
2000mm aluminium	96TA-20	36.20	96TA-20	36.20		
3000mm aluminium	96TA-30	54.40	96TA-30	54.40		
4000mm aluminium	96TA-40	72.50	96TA-40	72.50		
6500mm aluminium	96TA-65	117.90	96TA-65	117.90		

TOP GUIDE CHANNELS

2000mm aluminium	94A-20	23.30	94A-20	23.30		
3000mm aluminium	94A-30	34.60	94A-30	34.60		
4000mm aluminium	94A-40	46.30	94A-40	46.30		
6000mm aluminium	94A-60	69.50	94A-60	69.50		
2000mm brass	94B-20	66.20	94B-20	66.20		
3000mm brass	94B-30	99.50	94B-30	99.50		
4000mm brass	94B-40	132.60	94B-40	132.60		
6000mm brass	94B-60	198.80	94B-60	198.80		
2000mm aluminium – anodised			900A-A20	52.70	900A-A20	52.70
3000mm aluminium – anodised			900A-A30	78.90	900A-A30	78.90
4000mm aluminium – anodised			900A-A40	105.30	900A-A40	105.30
6000mm aluminium – anodised			900A-A60	158.00	900A-A60	158.00



96TA
TOP GUIDE



900A GUIDE CHANNEL



94 GUIDE CHANNEL



Timberoll

55

170

270



91 BRACKET



ISS/250 BRACKET



5SS/250 BRACKET



113RB/94 TOP GUIDE ROLLER

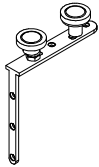

203SS/900 TOP GUIDE ROLLER



913SB BOTTOM ROLLER



913SBA BOTTOM ROLLER



913N BOTTOM ROLLER

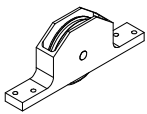

916 BOTTOM ROLLER

BOTTOM RAIL SECTIONS



815

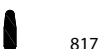

817

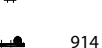

914

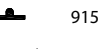

915



917



918

INTERLOCK

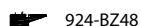

924-BZ48

Maximum door weight	55kg	170kg	270kg
Maximum door height	2600mm	2600mm	3300mm
Minimum door thickness	25mm	35mm	44mm

TOP GUIDE BRACKETS

	Ref. No.	Price \$	Ref. No.	Price \$	Ref. No.	Price \$
Face fitted – single line – stainless – one only	91	3.80	91	3.80		
Face fitted – single line – stainless – pack of 5	91/5	18.30	91/5	18.30		
Face fitted – single line – stainless – pack of 8	91/8	29.30	91/8	29.30		
Face fitted – single line – cast stainless steel			ISS/250	13.90	ISS/250	13.90
Face fitted – double line – cast stainless steel			5SS/250	36.00	5SS/250	36.00

TOP GUIDE ROLLERS – 2 per door

Top plate fitting – cast stainless steel roller bearing	106RB/94	17.70	106RB/94	17.70		
Angle plate fitting – cast stainless steel roller bearing	113RB/94	15.50	113RB/94	15.50		
Angle stainless steel – double nylon roller			203SS/900	58.30	203SS/900	58.30

BOTTOM ROLLERS – 2 per door

Nylon roller, silver steel axle in zinc plated steel body	913N	12.90				
Brass roller, ballrace in stainless steel body			913SB	51.80		
Brass roller ballrace in stainless steel body with vertical adjustment			913SBA	41.40		
Brass roller, roller bearing in aluminium body					916	174.50

BOTTOM RAILS

2000mm aluminium – drilled & countersunk	915A-20	28.40				
3000mm aluminium – drilled & countersunk	915A-30	42.60				
4000mm aluminium – drilled & countersunk	915A-40	56.70				
2000mm brass – drilled & countersunk	914B-20	44.20	914B-20	44.20		
3000mm brass – drilled & countersunk	914B-30	66.20	914B-30	66.20		
4000mm brass – drilled & countersunk	914B-40	88.20	914B-40	88.20		
6000mm brass – drilled & countersunk	914B-60	132.40	914B-60	132.40		
2000mm brass – drilled & countersunk			918-20	72.10	917-20	100.20
3000mm brass – drilled & countersunk			918-30	108.00	917-30	150.30
4000mm brass – drilled & countersunk			918-40	144.10	917-40	200.40
6000mm brass – drilled & countersunk			918-60	216.20		
2000mm brass – undrilled			815-20	91.90	817-20	167.40
3000mm brass – undrilled			815-30	137.80	817-30	251.00

ACCESSORIES

Interlocker Bronze Anodised 4800mm	924-BZ48	69.30	924-BZ48	69.30	924-BZ48	69.30
Flush Pull – Titanium Gold	401B	17.70	401B	17.70	401B	17.70
Flush Pull – Polished Nickel	401C	17.70	401C	17.70	401C	17.70
Flush Pull – Satin Nickel	401S	17.70	401S	17.70	401S	17.70
Flush Bolt – Door Standard – Titanium Gold	456TG	59.50	456TG	59.50	456TG	59.50
Flush Bolt – Door Standard – Polished Nickel	456PN	59.50	456PN	59.50	456PN	59.50
Flush Bolt – Door Standard – Satin Nickel	456SN	59.50	456SN	59.50	456SN	59.50
Door stop – nylon – wall or floor mounted	110N	3.30				
Door stop – Polished Brass			110PB	18.30	110PB	18.30
Door stop – Satin Chrome			110SC	18.30	110SC	18.30

