

ROBERUNNER "ULTRA"

Wardrobe & Cupboard Sliding Door Track System
32 kg Per Door

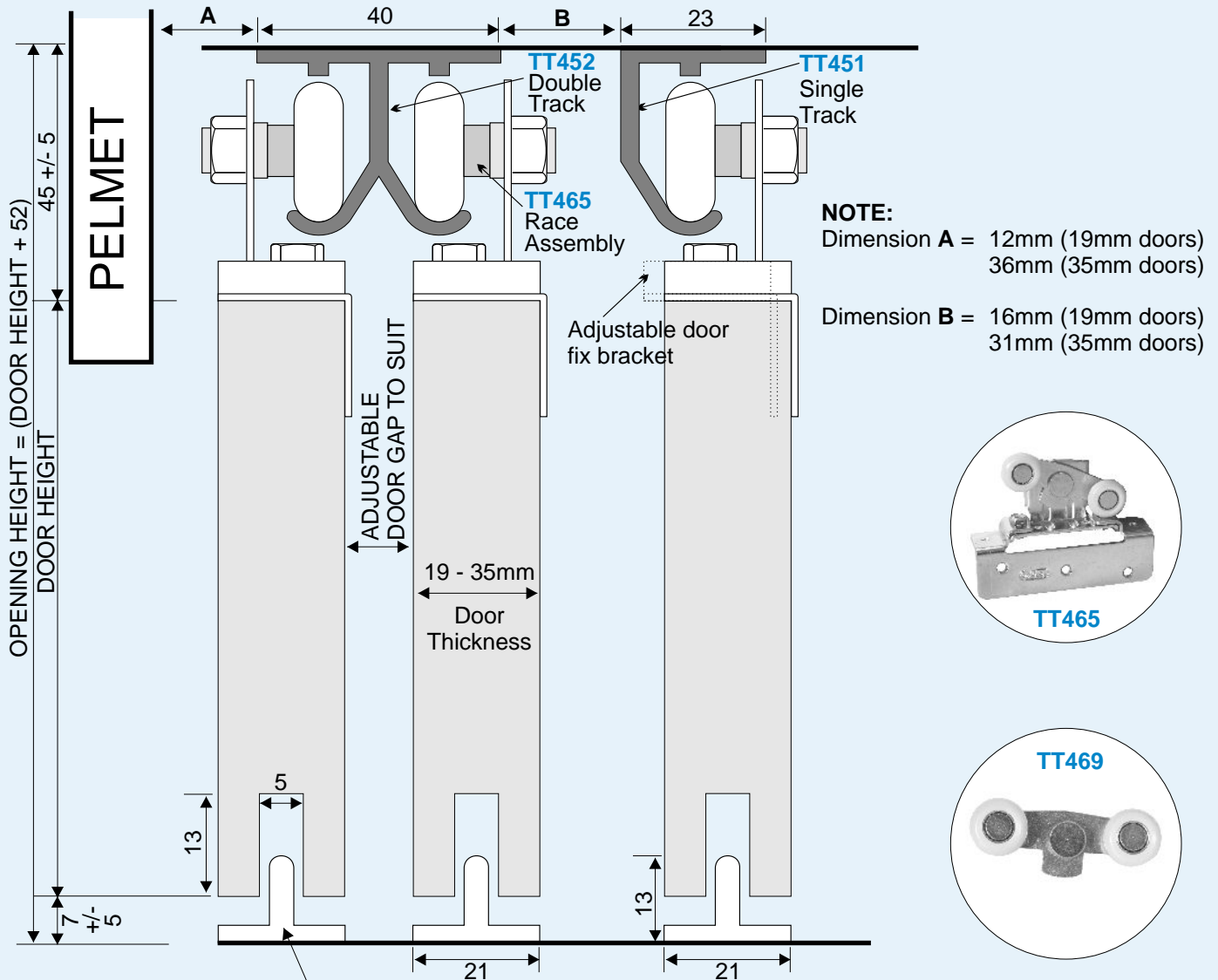

NOTE:

Dimension A = 12mm (19mm doors)
36mm (35mm doors)

Dimension B = 16mm (19mm doors)
31mm (35mm doors)

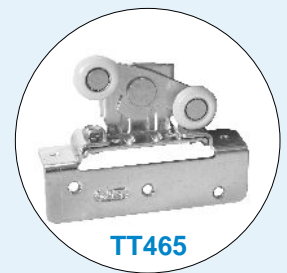

TT30
DOOR GUIDE

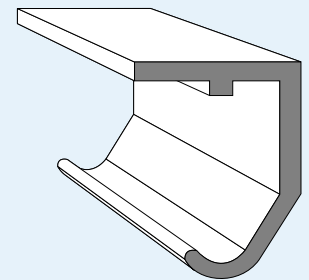
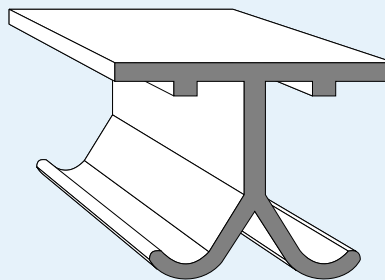

FEATURES:

- *Maximum load of 32kg per door
- *Nylon wheels on pivoting rocker arm with lubricated ball bearings for quiet and smooth running
- *Adjustable door mount brackets allow for varying door thicknesses
- *Height adjustment slot for accurate door alignment
- *Door gap adjustment slots suits 19 to 35mm doors
- *Rear side fix bracket - not visible from front
- *Anti-jump lip built into track
- *Zinc plated steel components resist corrosion
- *Extruded aluminium single or double track
- *Available packaged or sold separately
- *Alternative door guides available



P464	Packaged Door Set for 2 Doors - 1500, 1800 & 2400mm
P465	Components Pack for 1 Door
S469	Pack of 2 TT469 Wheels with Axle & Nut
S30	Pack of 2 TT30 Nylon Door Guides
TT452	Aluminium Double Track - 2000mm & 4500mm
TT451	Aluminium Single Track - 2000mm & 4500mm